

## Balanced Pressure Proportioner PPW MK2

### General Description

An accurate proportioner for foam concentrate is vital for the correct performance of a foam system, irrespective of flow and pressure variations.

SKUM PPW Mk2 proportioners provide more accurate proportioning and have a wider flow range with a lower line pressure drop than the original units.

### Application Description

This type of proportioner is used in foam pump and closed head sprinkler systems. The PPW series is designed for monitor and deluge systems or where large flow variations occur.

### Product Features

- Designed to meet the requirements of EN 13565:1 and NFPA 16 Ch 4
- Factory set to deliver accurate foam proportioning at 1, 2 and 3%
- Corrosion resistant materials
- Maximum/minimum flow rate ratio of 120:1
- Maintenance free design
- Compact design
- Foam proportioning from as low as 100 l/min
- Wafer type water connections

### Connections

- Water: wafer mounted between flanges, see table
- Foam: flanged to fit DIN PN 16 or ANSI 150 lbs

### Operation

Fully automatic foam proportioning within the flow and pressure range. The foam inlet pressure must be at least 1 bar higher than the water pressure.

### Installation

A minimum of five diameters (D) of straight pipe is required in the water line before entering the proportioner and three diameters (D) after the proportioner.



PPW-200

### Listings and Approvals

- Tested according to and complying with EN 13565:1
- Russian State Fire Academy
- Det Norske Veritas (DNV)
- Russian Maritime Register of Shipping (RMRS)

### Order Information - Please Specify

1. Part Number
2. Size
3. Foam proportioning %
4. Foam type

### Pressure Drop

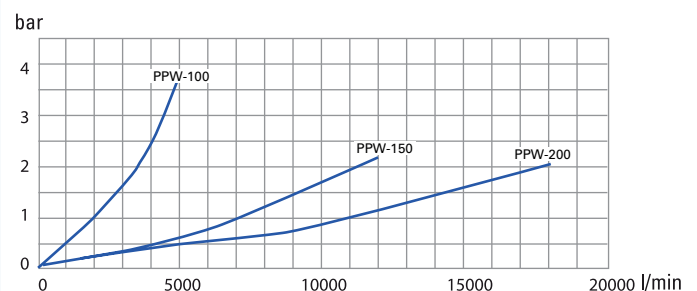

**PPW 100/150**

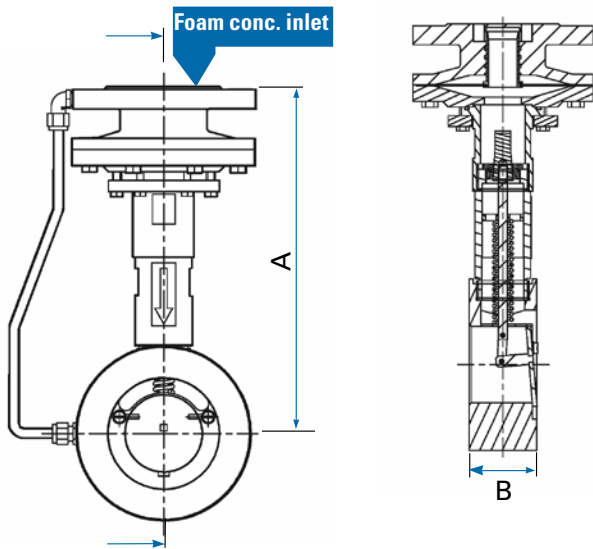

**PPW 200**

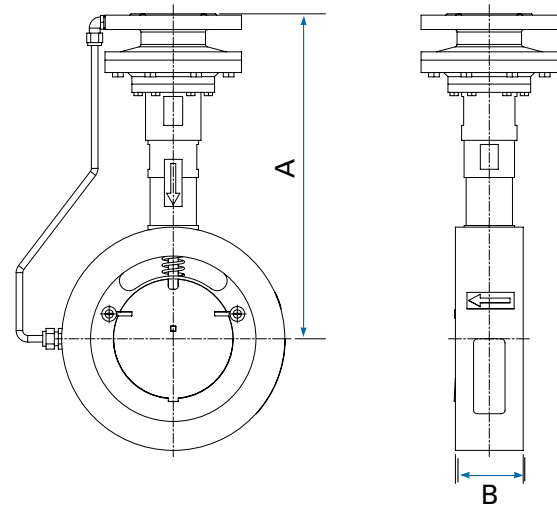

For dimensions A and B please see table below

**Foam conc.**

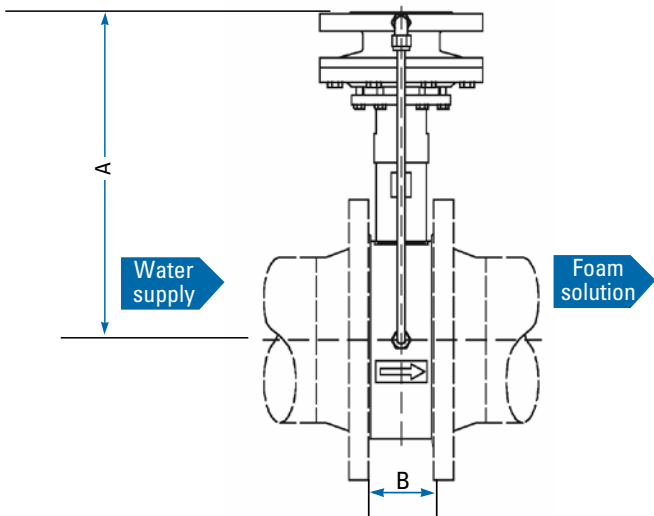

**Dimensions PPW MK2**

Type	A mm	B mm
■ PPW-100	312	62
■ PPW-150	333	62
■ PPW-200	393	82

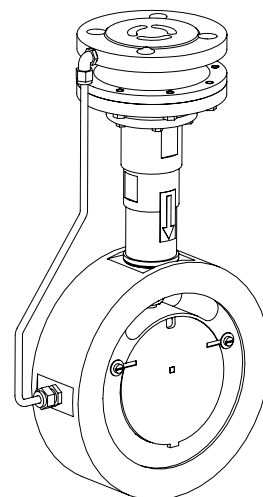
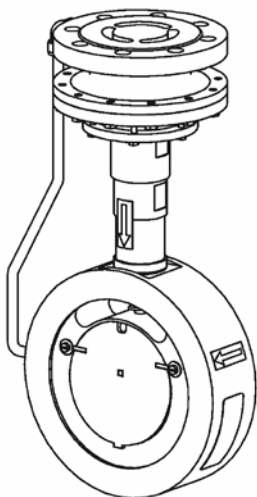

## Performance Data

Type	Connection		Capacity Min.		Capacity Max.		Weight		Material
	Foam*	Water	l/min	USGPM	l/min	USGPM	kg	lbs	
PPW-100	50 / 2"	100 / 4"	100	26	5,000	1,321	19	42	Bronze (Cu88Sn12)
PPW-150	50 / 2"	150 / 6"	100	26	12,000	3,170	22	48	Bronze (Cu88Sn12)
PPW-200	50 / 2"	200 / 8"	175	46	18,000	4,756	44	97	Bronze (Cu88Sn12)

\* Flanges to fit DIN PN 16 or ANSI 150 lbs

\*\* Maximum flow at 6% is reduced

1 bar = 0.1 MPa = 14.5 psi

Part No.	Description
■ 123510103A	PPW-100 DIN/ANSI 3% AFFF
■ 123510103C	PPW-100 DIN/ANSI 3% AR
■ 123510103E	PPW-100 DIN/ANSI 2%
■ 123510103B	PPW-100 DIN/ANSI 1%
■ 123515107A	PPW-150 DIN/ANSI 3% AFFF
■ 123515107C	PPW-150 DIN/ANSI 3% AR
■ 123515107E	PPW-150 DIN/ANSI 2%
■ 123515107B	PPW-150 DIN/ANSI 1%
■ 123520114A	PPW-200 DIN 3% AFFF
■ 123520114C	PPW-200 DIN 3% AR
■ 123520114E	PPW-200 DIN 2%
■ 123520114B	PPW-200 DIN 1%
■ 123520215A	PPW-200 ANSI 3% AFFF
■ 123520215C	PPW-200 ANSI 3% AR
■ 123520215E	PPW-200 ANSI 2%
■ 123520215B	PPW-200 ANSI 1%

## Foam Concentrate Mix Suffix

Foam Type	Suffix
■ AFFF/P/FP 3%	A
■ AFFF/AR 1%	B
■ AR AFFF 3%	C
■ HotFoam 2%	E