

Stationary Medium Expansion Foam Generator MRM

General Description

The MRM is a medium expansion foam generator, designed for fixed installation.

Application Description

For coverage of banded areas, under dock protection, spill fires and protection of basins and loading facilities where a layer of medium expansion foam is required.

Product Features

- Stainless steel body
- Hot-dipped slip-on galvanised flange and brass nozzle
- Easy to install
- Large area coverage
- Suitable for indoor and outdoor use
- Capacity up to 2,000 l/min

Connections

- Flanged to fit DIN PN16 or ANSI B 150 lbs

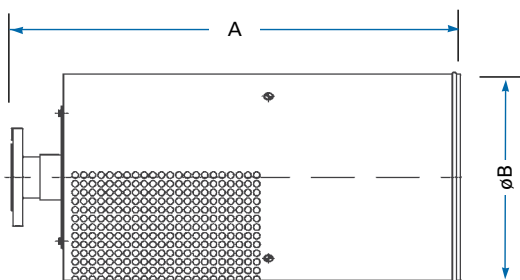

For dimensions A and B please see table on back



Order Information - Please Specify

1. Part Number
2. Size
3. Connection: DIN or ANSI
4. Capacity

<u>Part No.</u>	<u>Description</u>
■ 102105114	MRM-50 DIN 200 l/min
■ 102105212	MRM-50 DIN 400 l/min
■ 102105163	MRM-50 ANSI 200 l/min
■ 102105261	MRM-50 ANSI 400 l/min
■ 102106110	MRM-65 DIN
■ 102106215	MRM-65 ANSI
■ 102108112	MRM-80 DIN
■ 102108217	MRM-80 ANSI

Performance Data

MRM	50F - 200		50F - 400		65F		80F	
■ Inlet pressure	3 bar	5 bar	3 bar	5 bar	3 bar	5 bar	3 bar	5 bar
■ Water capacity	155 l/min	200 l/min	310 l/min	400 l/min	620 l/min	800 l/min	1,550 l/min	2,000 l/min
■ k-factor	89		178		358		895	
■ Foam expansion ratio approx*	40:1		40:1		40:1		40:1	
■ Dimensions A	710 mm		710 mm		830 mm		850 mm	
■ Dimensions B	240 mm		240 mm		380 mm		380 mm	
■ Connection	50 DIN PN 16 or 2" ANSI 150 lbs		50 DIN PN 16 or 2" ANSI 150 lbs		65 DIN PN 16 or 2½" ANSI 150 lbs		80 DIN PN 16 or 3" ANSI 150 lbs	
■ Weight	10 kg / 22 lbs		10 kg / 22 lbs		15 kg / 33 lbs		15 kg / 33 lbs	
■ Range of jet	3-5 mtr		3-5 mtr		3-5 mtr		3-5 mtr	
■ Material: Body	Stainless Steel		Stainless Steel		Stainless Steel		Stainless Steel	
■ Material: Nozzle	Brass		Brass		Brass		Brass	
■ Material: Range	Galvanised Steel		Galvanised Steel		Galvanised Steel		Galvanised Steel	

*Depending on foam concentrate type
 1 bar = 0.1 MPa = 14.5 psi