



### Tank Foam Chamber

The TFC and TFC 30D, Tank Foam Chamber and FD, Foam Deflector is designed for extinguishing fires in fixed roof storage tanks using compressed air (CAF) system. It is designed to give a quick, gentle and even spread across the full fuel surface. The design will help the compressed air foam finished product to move to the center of large diameter tanks. It does not direct the foam back into the tank shell but rather directs it forward into the tank.

The CAF foam has proven to have superior performance on fuel surfaces compared to normal low expanded foam. The TFC 30D is designed to give easy access from tank roofs with protection railing during testing. All TFC units has a built in gas-stop which can be left in place during testing. Foam Generators are defined by NFPA 11 as Type II discharge outlets for delivering foam to the surface of a flammable liquid.

The CAF generators are to be used in combination with TFC to complete the CAF system.

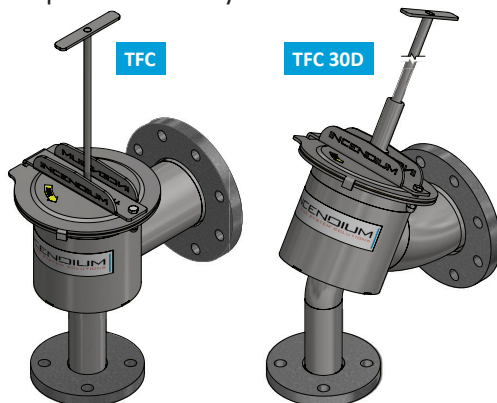

#### Material:

- Body\*: Stainless steel (316/316L)
- Internals\*: Stainless steel (316/316L)
- Nozzle: Stainless steel (316/316L)
- Flanges\*\*: Galvanized Steel

\* Carbon Steel optional \*\*Stainless Steel optional

#### Product Features

- Stainless Steel body (Carbon steel optional)
- Available with foam testing facility (optional)
- Easy access inspection from tank roof, especially the TFC 30D
- Allows foam testing without breaking built in vapour seal
- Simple installation and maintenance
- Removable orifice between inlet flanges
- Standard or custom made foam deflectors depending on tank design

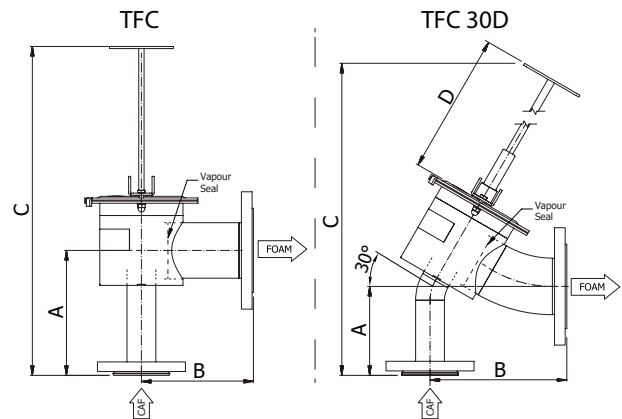

#### DIMENSIONAL DATA

| Model       | Length [mm] |     |      |      | Inlet*      | Outlet*     | Weight TFC + FD [kg] |
|-------------|-------------|-----|------|------|-------------|-------------|----------------------|
|             | A           | B   | C    | D    |             |             |                      |
| TFC-50      | 233         | 210 | 615  | N/A  | DN50 or 2"  | DN100 or 4" | 14 + 1               |
| TFC-100     | 265         | 210 | 680  | N/A  | DN100 or 4" | DN150 or 6" | 24 + 2               |
| TFC-50 30D  | 167         | 256 | 1310 | 1100 | DN50 or 2"  | DN100 or 4" | 17 + 1               |
| TFC-100 30D | 205         | 369 | 1535 | 1100 | DN100 or 4" | DN150 or 6" | 27 + 2               |

\* Inlet/Outlet Connections: DIN PN16 or ANSI 150 lbs

All parts have been selected for reliable and trouble free service using corrosion resistant materials for low maintenance.

#### PERFORMANCE DATA

| Model       | Inlet Pressure [bar/psi] | Capacity [lpm/gpm] |
|-------------|--------------------------|--------------------|
| TFC-50      | 2-3 / 30-40              | 230-380 / 60-100   |
| TFC-100     | 2-3 / 30-40              | 570-950 / 150-250  |
| TFC-50 30D  | 2-3 / 30-40              | 230-380 / 60-100   |
| TFC-100 30D | 2-3 / 30-40              | 570-950 / 150-250  |

#### Foam Deflector FD

The FD is inserted through flanged connections on the tank and ensures that the compressed air foam is spread evenly along the tanks inner wall. For insulated tanks, please contact Incendium.

