

STEP 1-2

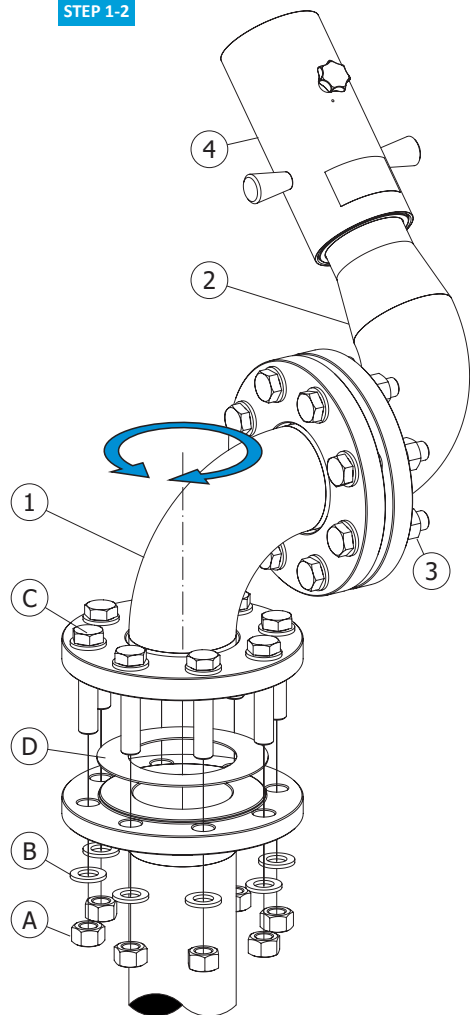

STEP 3

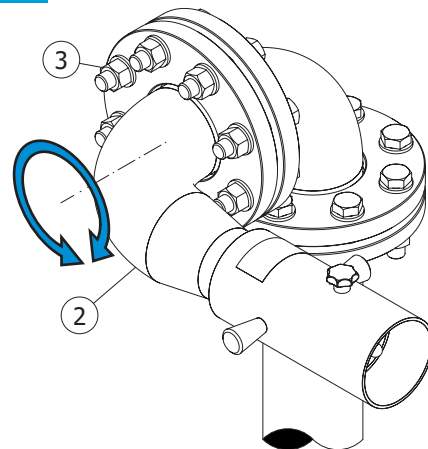

STEP 4-5

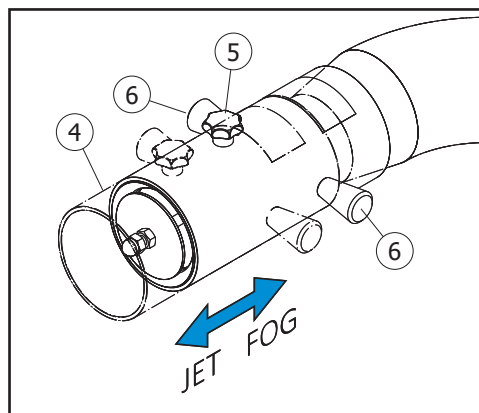

Instruction:

1. Connect the MON rotation flange on stand pipe using bolted connection with a gasket. Installation kit available upon request.
2. Rotate the Rotation Unit (1) until Fog/Jet Nozzle (4) is pointing towards protected area.
3. Loosen (3) and rotate Elevation Unit (2) until a suitable angle is reached. This is a step that will have to be redone after water activation until satisfactory aim has been achieved.
4. The water stream is adjusted between fog and jet using the Fog/Jet Nozzle (4). To adjust, unscrew the fixation screw (5) ~1 rotation until the outer pipe of the Nozzle unit can be moved back and forth using the handles (6). This can be done when water is running to ensure that the stream adjustment is set correctly.
 Re-tighten the fixation screw (5) when stream adjustment is complete. A combination of going through step 3 and 4 can be needed to achieve a satisfactory extinguishing setting.
5. (Optional) If no factory setting has been set for flow and pressure, please contact incendium for further instructions.

Note: Contact Incendium for installation kit, drawings or other assistance.

IMPORTANT:

Tighten bolted connections (A+3) in cross patterns to ensure correct gasket seal.

PARTS LIST, STANDARD

| POS | TYPE |
|-----|----------------------------------|
| 1 | Rotation Unit |
| 2 | Elevation Unit |
| 3 | Elevation Unit Bolted Connection |
| 4 | Fog/Jet Nozzle |
| 5 | Fog/Jet Fixation screw |
| 6 | Fog/Jet Handle |

PARTS LIST, INSTALLATION KIT

| POS | TYPE |
|-----|--------|
| A | Nut |
| B | Washer |
| C | Bolt |
| D | Gasket |